

1604 Avex

Countersunk head · Aluminium body · Steel stem · Multi-grip
3.2 mm (1/8") - 4.8 mm (3/16")

Features

- Multi-grip capability accommodates wide variations in material thickness
- Good hole fill provides strong, vibration resistant joints
- Compensates for irregular, oversized, slotted or misaligned holes
- Can stop sheet movement in non-standard holes
- Retained stem avoids damage, electrical problems or rattling caused by loose stems
- Provides a large blind side bearing area against the rear sheet
- Spreads the tail bearing load/clamp load on the rear sheet making it ideal for use in thin sheet materials

Material

- Body: Aluminium alloy (2.5% Mg) AA5052, natural
- Stem: Low carbon steel, zinc coated

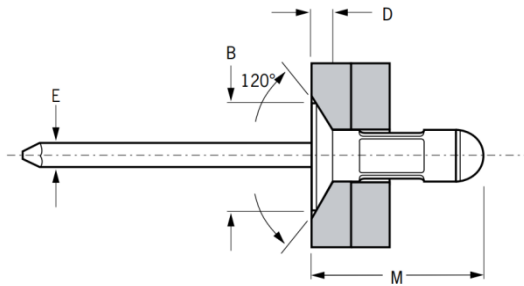

Before Placement

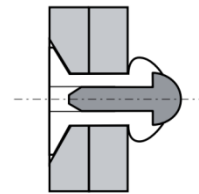

After Placement

Part No.	Size ø	Grip Range		Hole Size		M max.	øB max.	D max.	øE max.	Shear (typical) kN	Tension (typical) kN
		min.	max.	min.	max.						
01604-00412	3.2 (1/8")	2.4	6.3	3.3	3.4	12.2	5.6	1.3	1.8	0.69	0.91
01604-00414		4.0	7.9			13.4					
01604-00416		5.5	9.5			14.8					
01604-00514	4.0 (5/32")	2.8	7.9	4.1	4.2	14.3	6.6	1.4	2.2	1.13	1.33
01604-00515		3.6	8.8			15.1					
01604-00615	4.8 (3/16")	3.2	7.9	4.9	5.0	15.5	9.0	1.8	2.9	1.55	2.35
01604-00621		6.3	12.7			20.4					



Can't find what you are looking for?

We can provide customized finishing and colouring.
Contact your nearest [Gripwell](#) team for assistance!